

Installing the Chain

WARNING

To prevent **SERIOUS INJURY**:

- DO NOT connect power until instructed.
- Keep hands and fingers clear from sprocket during operation.
- Wear gloves when installing chain/belt and cable.
- Keep hands and fingers away from joints and possible sharp edges.

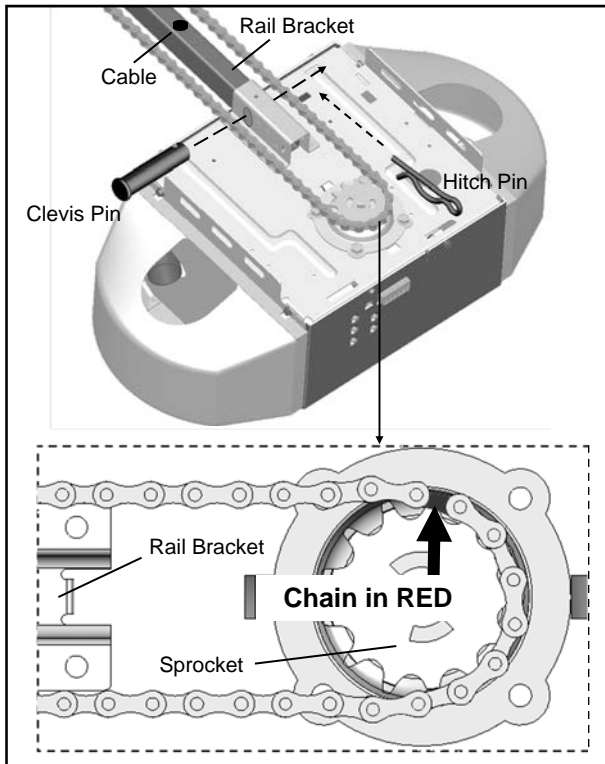

Fig.1

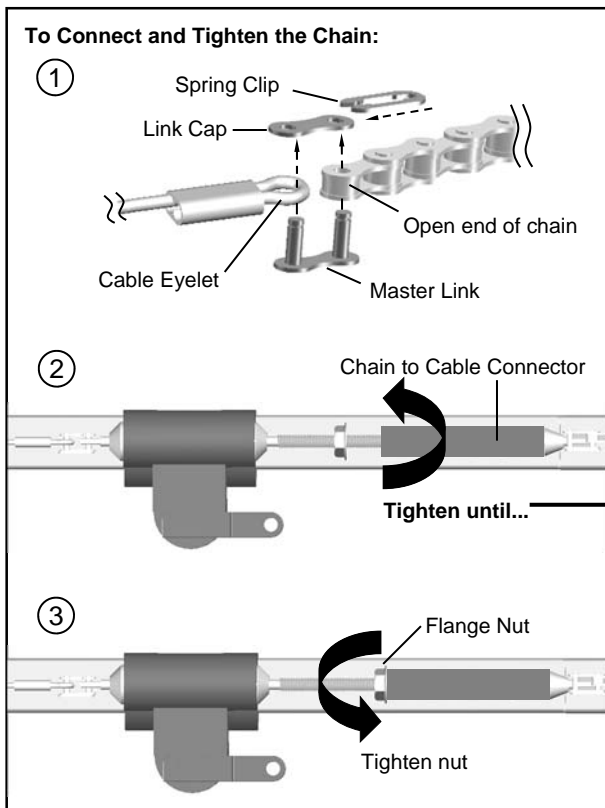

Fig.2

To Install Chain

1. Pull the remaining chain along the rail toward the Opener.
2. Insert a 5/16" x 1-1/2" Clevis Pin through the hole and lock it into position with a Hitch Pin.
3. A segment of chain marked in RED will be seen. Place this segment in the approximate location on the sprocket as shown in Fig.1.
4. When the chain is aligned properly around the sprocket, pull the Chain-to-Cable Connector towards the Trolley Shaft.

Follow steps shown in Fig.2 to connect & tighten the chain:

1. Align the open end of the chain to the Cable Eyelet and connect together using the Master Link Set.
2. Turn the Chain-to-Cable Connector on the Trolley Shaft until the chain is about 1/4" (6mm) above the base of the rail. Compare with the illustration below.
3. Tighten the Flange Nut on Trolley Shaft against the Chain-to-Cable Connector.

When the chain and cable are tightened around the rail and sprocket on the Opener, check and make sure the chain is properly aligned and not twisted. Attach the Sprocket Cover to the Opener as shown in Fig.3.

Notice

During operation, it is normal for the chain to appear loose when the door is closed. If the chain returns to the position as shown below when the door is opened, the chain is adjusted properly. DO NOT re-tighten the chain.

When performing maintenance, always PULL the Emergency Release to DISCONNECT the door from Opener before adjusting the chain.

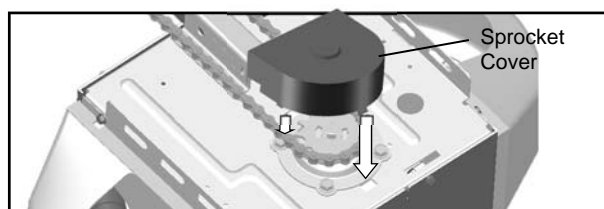
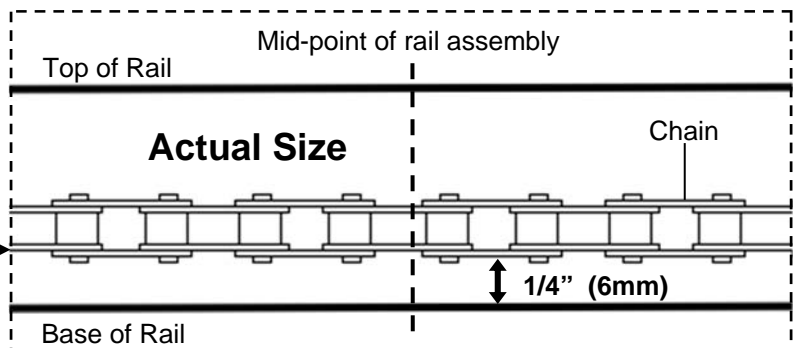

Fig.3